

Name **Gio**

Date **-**

Temp. **-**

Track **Sitterdorf**

Traction **Good**

Engine **Picco Evo 2**

1/8th Scale 4WD Gas Powered Racing Car



P8.0

MOTONICA

SETUP

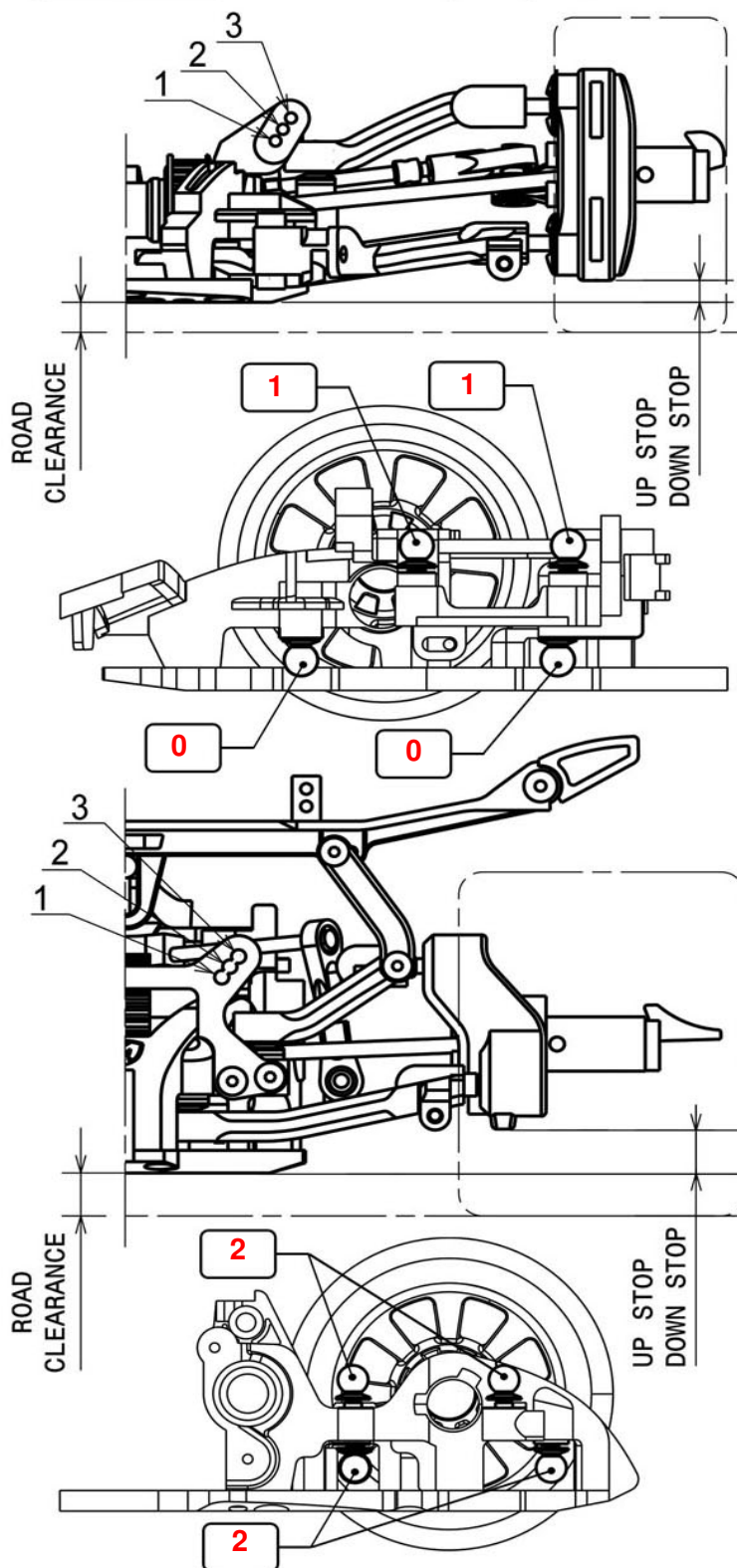

Front Suspension

Up Stop	-
Down Stop	2mm
Front width	252mm
Toe Angle	1.5°
Camber Angle	2/2.5
Caster	2mm dietro
Front Antiroll Bar	
Shock Oil	400
Shock Piston	1 buco
Spring	Mugen Bianca
Spring Adjuster	.
Shock Pos	3

Tyre Type	MMT
Tyre Hardness	35
Tyre Diameter	68
Road Clearance	6.5mm

Rear Suspension

Up Stop	-
Down Stop	4mm
Rear width	262mm
Toe Angle	2.5°
Camber Angle	2.5/3
Rear Antiroll Bar	
Shock Oil	400
Shock Piston	2 buchi
Spring	Motonica Nera
Spring Adjuster	-
Shock Pos	2

Clutch Shoe	GR	Pinion Gear	16/19
Clutch Spring	GR	Spur Gear	49/46
Clearance	0,7		
Adj Nut	1mm	Rear Spoiler	2mm

Tyre Type	MMT
Tyre Hardness	35
Tyre Diameter	75
Road Clearance	8.5mm